

PLANTA ANTERIOR

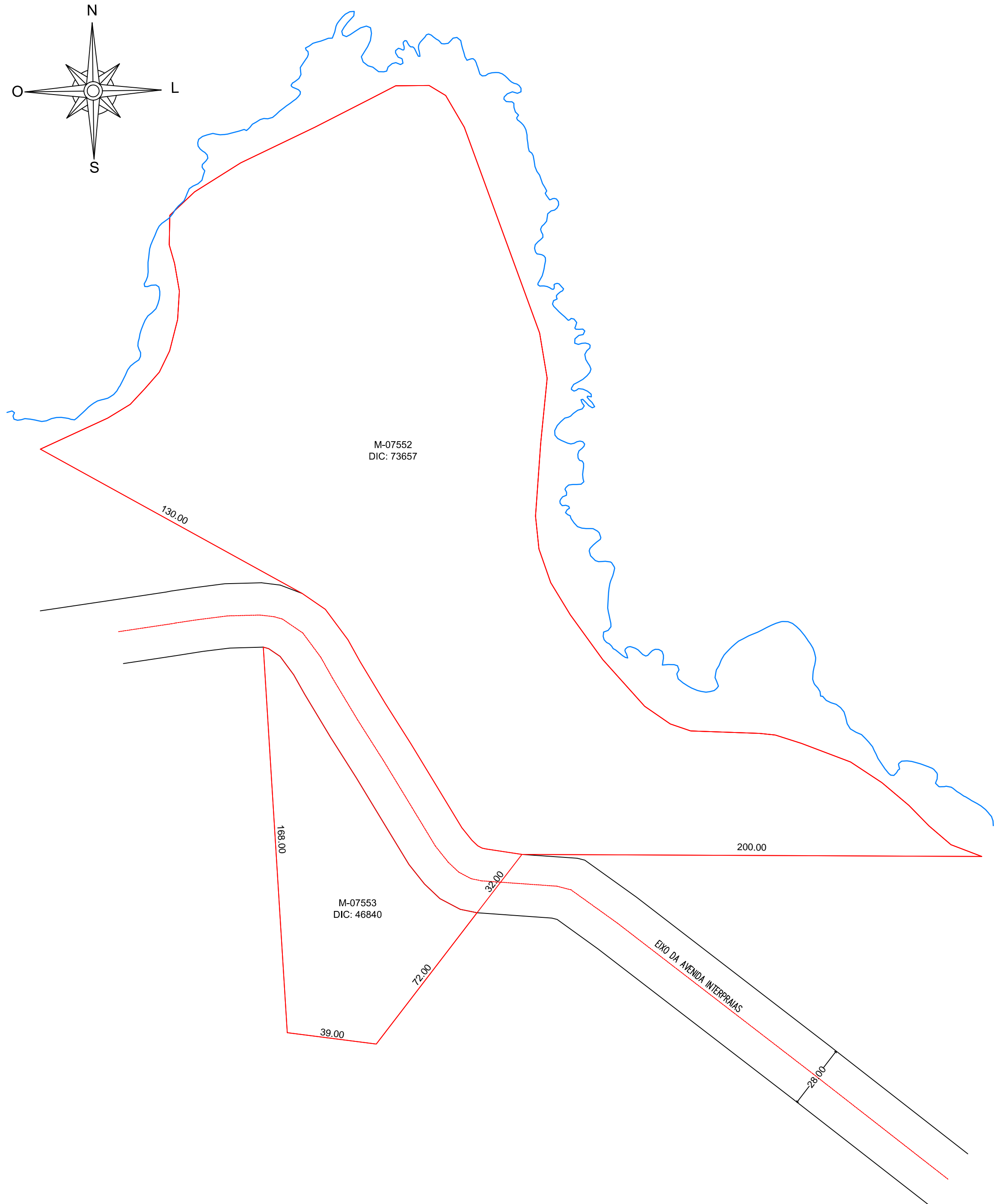

PLANTA CONFORME ÁREA ENCONTRADA

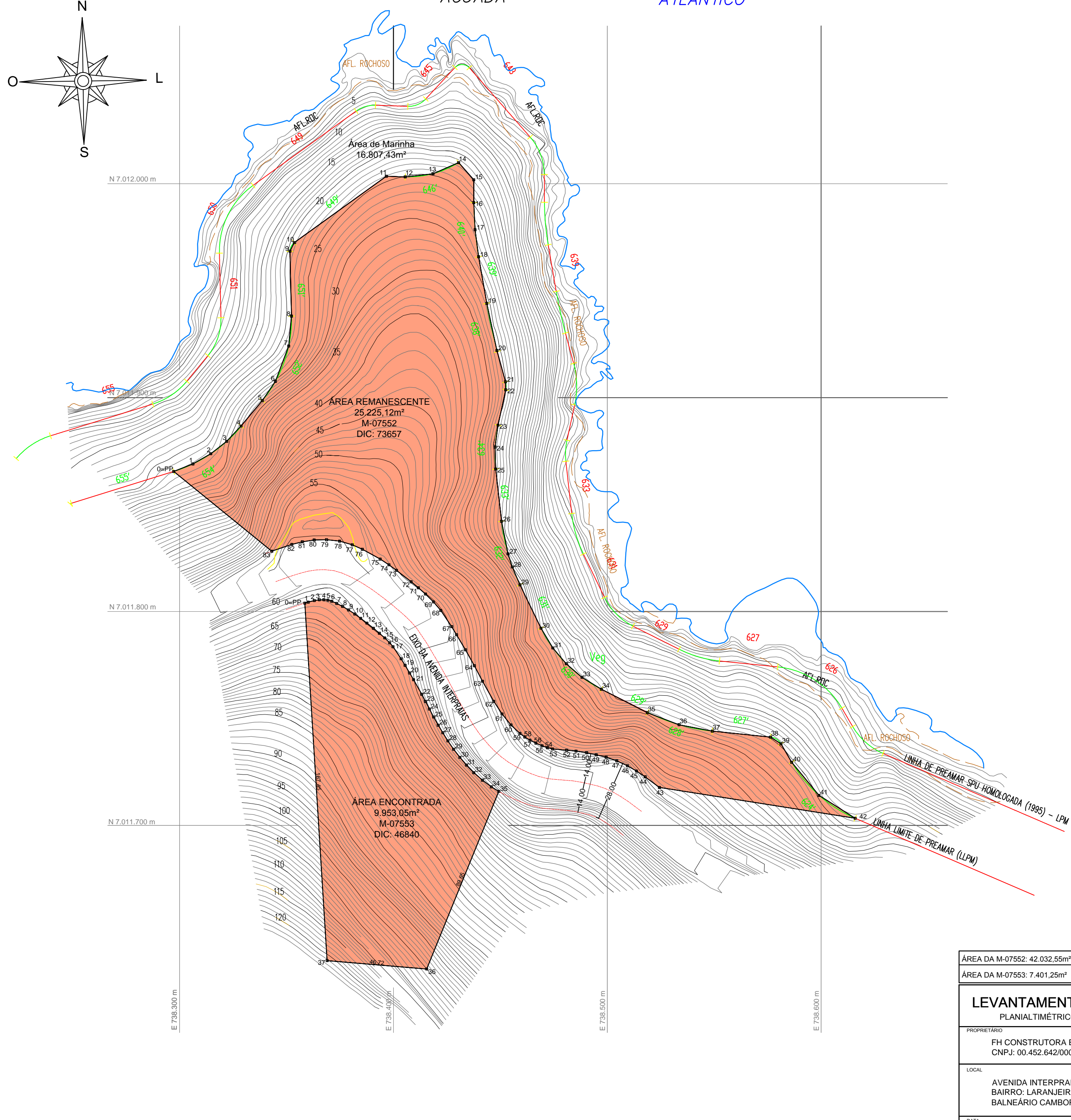

QUADRO DE AZIMUTES, DISTÂNCIAS E COORDENADAS UTM SIRGAS 2000

Vértice	Para	Azimute	Distância	Coord. Norte	Coord. Este
0-PP	1	68°36'15"	9,63	7011865,491	738297,258
1	2	60°17'32"	9,64	7011869,005	738306,227
2	3	52°02'58"	9,47	7011873,883	738314,802
3	4	42°58'57"	9,79	7011879,609	738322,072
4	5	40°00'00"	15,48	7011886,774	738328,749
5	6	34°19'13"	10,84	7011893,651	738336,698
6	7	29°36'18"	17,70	7011907,596	738344,812
7	8	5°19'38"	14,04	7011924,150	738351,040
8	9	358°38'38"	30,37	7011938,131	738352,343
9	10	270°00'00"	4,49	7011943,493	738351,607
10	11	54°13'13"	53,09	7011972,491	738353,648
11	12	92°08'43"	8,82	7012003,531	738396,718
12	13	83°27'30"	13,07	7012003,201	738405,528
13	14	66°26'25"	13,06	7012004,690	738418,516
14	15	138°42'30"	10,71	7012009,911	738430,488
15	16	180°00'00"	10,66	7012001,861	738437,558
16	17	177°09'39"	12,71	7011991,201	738437,558
17	18	172°34'26"	12,73	7011978,504	738438,188
18	19	170°00'00"	22,12	7011965,882	738439,833
19	20	161°47'04"	22,54	7011944,098	738443,671
20	21	164°37'32"	15,19	7011922,060	738448,380
21	22	178°19'11"	3,75	7011907,401	738452,408
22	23	182°19'36"	18,91	7011903,651	738452,518
23	24	187°38'04"	10,31	7011887,131	738448,908
24	25	178°19'57"	10,31	7011876,509	738447,538
25	26	173°39'25"	24,55	7011866,601	738447,338
26	27	168°45'17"	15,52	7011842,202	738450,549
27	28	161°50'14"	6,45	7011826,978	738453,576
28	29	156°56'46"	9,09	7011820,849	738455,587
29	30	154°03'31"	22,55	7011812,481	738459,148
30	31	149°04'28"	10,76	7011792,203	738469,013
31	32	139°44'16"	9,85	7011782,975	738474,541
32	33	130°49'41"	9,78	7011761,611	738480,178
33	34	121°28'20"	10,62	7011769,216	738488,179
34	35	117°00'00"	24,10	7011763,671	738497,238
35	36	110°50'04"	15,88	7011752,732	738498,707
36	37	109°59'19"	15,85	7011747,083	738503,551
37	38	95°50'08"	27,40	7011744,061	738549,110
38	39	122°35'41"	5,75	7011741,276	738576,368
39	40	150°00'00"	9,98	7011738,181	738581,208
40	41	140°25'52"	20,05	7011729,538	738586,198
41	42	122°23'50"	20,05	7011714,066	738598,983
42	43	278°26'49"	92,67	7011703,352	738615,910
43	44	308°47'34"	8,33	7011717,737	738624,373
44	45	303°39'35"	4,89	7011722,724	738617,703
45	46	300°45'59"	4,88	7011725,432	738613,637
46	47	294°45'00"	5,50	7011727,877	738609,417
47	48	288°47'46"	5,18	7011730,178	738604,426
48	49	283°46'36"	4,79	7011731,848	738609,518
49	50	282°25'51"	4,62	7011732,988	738604,870
50	51	278°39'25"	5,05	7011733,983	738600,354
51	52	275°11'37"	4,36	7011734,737	738598,365
52	53	275°06'31"	6,82	7011735,132	738601,018
53	54	283°50'30"	2,55	7011735,721	738604,426
54	55	289°32'25"	2,84	7011737,331	738611,952
55	56	293°33'29"	3,13	7011741,296	738618,707
56	57	296°28'52"	3,06	7011738,466	738606,592
57	58	301°22'31"	2,81	7011739,830	738603,854
58	59	300°30'11"	2,86	7011741,296	738618,707
59	60	313°23'16"	5,80	7011742,999	738659,156
60	61	320°55'08"	6,60	7011746,983	738654,942
61	62	330°51'16"	7,04	7011752,105	738650,769
62	63	330°40'54"	10,81	7011758,006	738646,943
63	64	332°12'35"	8,17	7011767,430	738641,651
64	65	330°48'33"	8,51	7011774,661	738637,840
65	66	329°22'23"	8,21	7011782,093	738633,685
66	67	329°07'49"	4,39	7011789,158	738629,505
67	68	326°02'39"	9,16	7011792,930	738627,250
68	69	319°26'24"	5,25	7011803,530	738622,133
69	70	314°33'15"	5,21	7011804,522	738618,716
70	71	311°22'35"	4,46	7011808,180	738615,000
71	72	309°59'39"	4,37	7011811,131	738611,650
72	73	307°48'41"	8,68	7011813,929	738608,297
73	74	306°11'50"	4,41	7011819,263	738601,437
74	75	303°16'12"	4,86	7011821,667	738597,878
75	76	298°47'52"	9,53	7011824,525	738593,812
76	77	293°45'26"	5,15	7011829,115	738585,463
77	78	286°13'44"	6,17	7011831,189	738580,748
78	79	278°03'21"	6,12	7011832,604	738574,828
79	80	269°02'43"	5,80	7011833,568	738568,742
80	81	261°08'03"	5,63	7011833,462	738562,945
81	82	253°49'08"	5,04	7011832,604	738557,383
82	83	251°28'48"	9,91	7011831,353	738552,496
83	0-PP	309°07'20"	59,09	7011828,206	738643,101

QUADRO DE AZIMUTES, DISTÂNCIAS E COORDENADAS UTM SIRGAS 2000

Vértice	Para	Azimute	Distância	Coord. Norte	Coord. Este
0-PP	1	72°32'00"	1,66	7011803,910	738358,567
1	2	75°45'08"	2,94	7011804,468	738360,150
2	3	81°09'03"	2,38	7011805,131	738362,998
3	4	89°02'43"	2,15	7011808,498	738365,348
4	5	96°03'21"	1,91	7011805,534	738367,494
5	6	106°13'44"	1,83	7011805,332	738369,996
6	7	115°45'26"	2,52	7011808,607	738371,150
7	8	116°59'09"	3,08	7011803,805	738373,460
8	9	120°36'01"	3,24	7011802,407	738376,206
9	10	123°16'12"	3,50	7011803,756	738376,997
10	11	126°11'50"	3,45	7011798,839	738381,919
11	12	127°12'35"	3,66	7011796,803	738384,701
12	13	128°22'19"	3,85	7011794,591	738387,814
13	14	129°50'39"	3,63	7011792,200	738390,634
14	15	131°22'35"	3,31	7011789,873	738393,423
15	16	134°33'15"	3,24	7011787,683	738395,909
16	17	139°26'24"	2,44	7011785,407	738398,220
17	18	146°02'39"	6,79	7011783,550	738399,810
18	19	149°07'49"	3,58	7011777,916	738403,604
19	20	149°22'23"	4,14	7011778,843	738405,441
20	21	149°22'23"	3,66	7011771,282	738407,549
21	22	150°48'33"	7,79	7011768,131	738409,415
22	23	152°20'21"	3,63	7011763,352	738413,213
23	24	152°04'37"	3,98	7011757,938	738414,992
24	25	152°32'35"	4,19	7011754,418	738416,857
25	26	150°11'25"	4,42	7011750,703	738418,788
26	27	148°48'41"	4,08	7011746,852	738420,965
27	28	148°06'25"	4,48	7011743,369	738423,079
28	29	145°40'03"	4,78	7011739,552	738425,448
29	30	142°09'04"	4,79	7011735,603	738428,145
30	31	139°40'17"	4,75	7011731,825	738431,081
31	32	136°07'18"	4,92	7011728,201	738434,157
32	33	130°53'39"	5,37	7011724,658	738437,644
33	34	126°35'01"	5,19	7011721,143	738441,622
34	35	121°22'31"	4,07	7011718,053	738445,796
35	36	202°05'21"	89,65	7011715,931	738449,265
36	37	274°48'55"	46,72	7011632,865	738415,553
37	0-PP	356°25'40"	167,45	7011636,786	738369,000

ÁREA DA M-07552: 42.032,55m²	ÁREA REMANESCENTE: 25.225,12m²	ÁREA=25.225,12 m²
ÁREA DA M-07553: 7.401,25m²	ÁREA ENCONTRADA: 9.953,05m²	ÁREA=1,04 Alqueires Paulistas
		Perímetro=1.007,79 m
LEVANTAMENTO TOPOGRÁFICO		
PLANIALTIMÉTRICO GEORREFERENCIADO		
PROPRIETÁRIO		
FH CONSTRUTORA E INCORPORADORA LTDA		
CNPJ: 00.452.642/0001-21		
LOCAL		
AVENIDA INTERPRAIAS		
BAIRRO: LARANJEIRAS		
BALNEÁRIO CAMBORIÚ-SC		
DATA	02/2019	ESCALA
		1/1400
RESPONSÁVEL TÉCNICO		
TEO JÚNIOR OSTERKAMP		
TÉCNICO EM AGRIMENSURA		
CRT -04 / CFT		